

IKI

KIUKAISTA KIUKAIN

Instructions for installation and use



**KIVI-IKI SL fireplace sauna
stove**

Instructions for installation
and use

4/2021

Read through these instructions carefully before installation and use.

This instruction manual is intended for the owner of the sauna, or the person responsible for the sauna's maintenance and upkeep. The manual must be handed over to the owner after installation has been completed.

Save these instructions for later use.

- When choosing the place for the stove, carefully calculate the appropriate safety distances to combustible materials.
- Ensure the floor's load bearing capacity and check the requirements for the flue connection pipe (angled or straight), or the installation route of a new metal chimney pipe.
- Read through the instructions carefully before installation and use.

ATTN! Use protective gloves and a long-sleeved shirt when handling the stove's mesh frame and when placing the stones into the stove as there may be rough edges in the frame.

Contact information

Technical support

(Mon-Fri 9-16)
+ 358 (0)600 550 133
(1,49 €/min + Inc)
tuki@ikikiuas.fi

IKI Kiuas Plc

Hakaniemenkatu 11
00530 Helsinki, Finland
ikikiuas@ikikiuas.fi

Helsinki Warehouse

Pälkäneentie 5
00510 Helsinki, Finland
vallila@ikikiuas.fi

Production , Pieksämäki

Niilontie 10
76150 Pieksämäki, Finland
tuotanto@ikikiuas.fi

Contents

1. SAFETY INSTRUCTIONS	3
2. WARRANTY	4
3. INSPECTING THE CONTENTS OF THE SHIPMENT AND INSTALLATION	6
3.1 Selecting the location for the stove.....	6
3.2 Preheating and commissioning the stove	6
3.3 Safety distances to flammable structures	7
3.4 Through-the-wall installation	7
3.5 Measurements and height for a 90-degree angled stove pipe	8
4. VENTILATION AND COMPENSATION AIR.....	9
5. INSTALLATION OF THE STOVE	10
5.1 Installation	10
5.2 Affixing the glass hatch.....	12
6. INSTRUCTIONS FOR USE	13
6.1 Lighting the fire.....	13
6.2 Care and upkeep.....	14
6.3 Trouble shooting.....	14
6.4 Instruction for sweeping.....	15
6.5 Protective base for the stove	16
7. WARNINGS.....	16

1. SAFETY INSTRUCTIONS

The stove may not be used for any purpose other than heating the sauna, such as for drying clothes or to heat a construction site, etc.

Covering the stove during use, or while it is still warm, is prohibited.

The use of sea water or other saline water is prohibited and will void the warranty.

Avoid touching and/or covering the stove's flue connection, the hatch, metal surfaces and the stones during and after use as they may be extremely hot! If you are required to touch them, use thermal protection gloves.

Pay special attention to safety when children are bathing in the sauna!

When installing the stove and replacing stones, watch out for any sharp edges in the frame; wear protective gloves and a long-sleeved shirt!

In addition to this manual, the installation and use of the stove must comply with EU sauna stove standard 15821, as well as the instructions and regulations placed by local fire authorities.

The warranty does not apply to defects caused by faulty installation or erroneous use.

2. WARRANTY

IKI Kiuas Ltd (the manufacturer) assures a warranty to its products as stipulated here, guaranteeing the quality and functionality of the products during the warranty period. The warranty applies to products sold and used in Finland. The warranty requires that the buyer follow the instructions regarding the location of the stove, its installation, use and maintenance as well as those regarding the stones used in the heater. The warranty period is 2 years, calculated from the day of purchase or the receipt of the new construction site where the product is located, depending on which is the latter date, but never exceeding 30 months from the date of purchase.

For saunas located in spas or other publicly used spaces, the warranty period is 1 year or depends on the frequency of use. The warranty does not apply to the stove's grate. Contact the manufacturer for addition information.

The warranty on wood-burning sauna stoves stipulates that:

1. In case of a defect, the buyer must always contact the manufacturer before searching for the cause or attempting to repair it.
2. In private use, the stone space needs to be cleaned and stones re-piled at least once a year and weathered stones need to be replaced with new ones.
3. In institutional/commercial use, the stones must be re-piled at least three times a year and replaced with new ones at least once a year. Proof must be presented at request, such as a receipt for the purchase of the product, a receipt for the construction site or a similar statement. The use of ceramic heater stones (other than those form **KERKES**) is prohibited. If such stones have been used, the manufacturer ceases to honour the warranty.
4. The warranty does not cover dismantlement or reinstallation on sauna benches, removal of sauna stones nor re-piling them.
5. **The warranty for replacement parts** is 1 year from the day of purchase. The replacement part will be delivered to the sales agent or directly to the buyer free of cost. The manufacturer is not liable to reimburse any costs due to the removal of the faulty part or the installation of the replacement. The faulty part must be returned to the manufacturer at request and at their expense. The manufacturer will issue its freight contact number for the delivery of the faulty part. Receipt from the retailer or certificate from a manufacturer's authorized mechanic will function as a warranty certificate. The warranty does not apply to the stove's grate.
6. **Limitations to warranty:** The product owner must take good care of the product. On receiving the product, the owner is expected to check that there is no sign of damage caused during shipping or storage. In case of such damage, the owner must contact the sales agent or transport company immediately. The manufacturer is not liable for any damages caused during shipping, or by inappropriate storage, installation or use against manufacturer's

instructions, neglect of maintenance, or damage caused by storing the stove in a place which does not meet the recommendations made by the manufacturer.

7. **Notification of damages:** The owner is responsible for notifying the sales agent of any damage or malfunction as soon as it appears and within 14 days. Warranty related claims must be submitted within 14 days from the closing date of the product's warranty period.
8. **Manufacturer's actions regarding warranty, continuation of warranty:** In receipt of a substantiated warranty claim, the manufacturer will repair or change the product. This is done in the manufacturer's expense, and the manufacturer is free to select the most cost-effective alternative. The warranty for replacement parts is outlined above. The replacement part is granted warranty according to the aforementioned specifications. The warranty for a repaired part continues as before. The manufacturer is not liable for reimbursing any expenses, business loss or other direct or indirect harm occurred to the buyer from damages or malfunction.
9. **Packaging the returns is the responsibility of the sender.** The products must be carefully packed to prevent further damage during transportation. At least 5 cm of padding should be placed around the product. IKI Kiuas Plc recommends using the original packaging, which has been designed for safe transport.
10. IKI Kiuas Plc is not responsible for any damage caused during transportation if the products have been packaged carelessly. The costs caused by an error or negligence on the part of the customer will be charged from the customer. If returns are made without reason or in violation of the terms of the contract, IKI Kiuas Plc reserves the right to charge the costs of handling and shipping from the customer.
11. **Quality guarantee:** The manufacturer guarantees the durability of the stainless-steel parts for 10 years. During the warranty period any defects that appear in the raw materials or are production-based will be repaired free of charge. For example, the use of seawater on the heater is prohibited.
12. The warranty does not cover colour changes, slipping or hair-line fractures, characteristic to natural stones, which do not affect the use or the safety of the stove. The warranty does not apply to the stove's grate.
13. **ATTN! Damages occurred during shipping must be recorded in the waybill when the product is received, or within 7 days of delivery. The damage must always be reported to the shipping company's last contact.** The damaged part needs to be stored for inspection. The shipping company's insurance will compensate for the costs. The replacement part will be delivered via a commercial shipping company.

3. INSPECTING THE CONTENTS OF THE SHIPMENT AND INSTALLATION

Check that all the required parts are included in the shipment:

- 1 pc furnace and bottom part of the mesh frame
- 1 pc coiled exhaust pipe
- 1 pc top part of the mesh frame
- 1 pc ash pan
- 1 pc grate
- 1 pc glass hatch (within a cardboard box)
- 2 pcs stove collar; 1 for the inside and 1 for the outside of the sauna room (stainless steel or black).

The delivery also includes 1 ash spatula, 1 connecting pipe and protective gloves for installation. If the stove will be connected to the IKI T600 chimney, a 30 cm adapter will also be included.

3.1 Selecting the location for the stove

- Check and measure the safety distances to flammable and non-combustible structures.
- Check the location of the flue connection (the height of an old chimney connection or the path of a new chimney).
- Check the floor material (combustible, non-combustible, tiled and waterproofed) and the floor's load-bearing capacity.
- Note that IKI stoves hold a lot of stones which weight a lot.
- IKI wood-burning stoves should ideally be installed into either a brick chimney, a ceramic chimney or an air-cooled chimney. The outer diameter of the stove outlet pipe is 115 mm.

3.2 Preheating and commissioning the stove

- Before laying the stones or bathing for the first time, preheat the stove outside or in a well-ventilated space to burn off protective oil solvents.
- In ordinary use, rough cut olivine diabase stones, less than 10cm in diameter, are recommended. The stones should be laid carefully, not too tightly, so that air can flow freely through the stove and heat up the sauna room.
- The storage of flammable materials (e.g., flammable liquids, etc.) in the proximity of the fireplace is prohibited.
- All soot fires (even once extinguished) must be reported to the fire authorities.
- The fireplaces and chimneys in a holiday home sauna, which is mainly in private use, must be swept every three years.
- The fireplaces and chimneys in permanent residential use and regularly used non-private holiday homes must be swept every year.

3.3 Safety distances to flammable structures

Please note that the gap between the furnace and the stove's mesh frame must be filled with stones. Safety distances to flammable structures (e.g., wood-panelled walls and wooden benches):

A: From the mesh frame, filled with stones, to the sides and back: 250 mm

B: From the exposed chimney pipe to the side: 500 mm
From the pipe upwards: 1000 mm

Note! From the stones upwards: 800 mm

C: From the furnace to the side: 300 mm

D: From the glass hatch to the front: 500 mm

The required distance for safety can be cut down by 50% when using fire protection boards, for example 1 mm metal/fibre board with a 30 mm air gap.

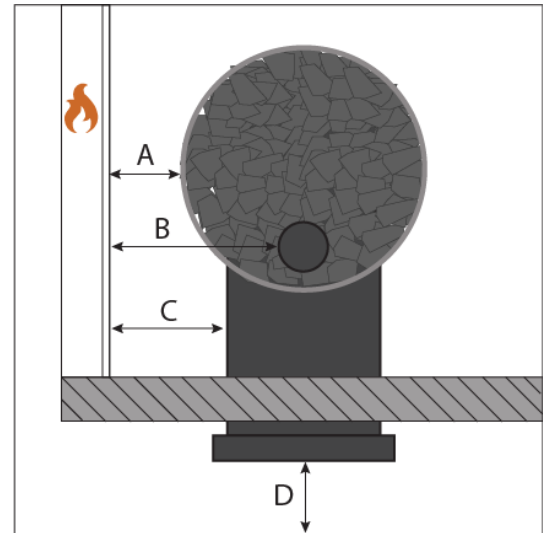

3.4 Through-the-wall installation

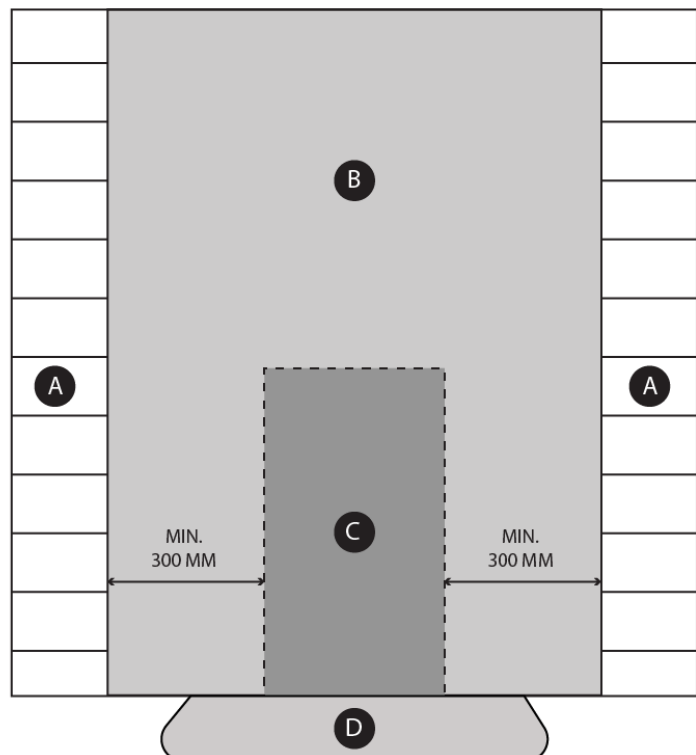
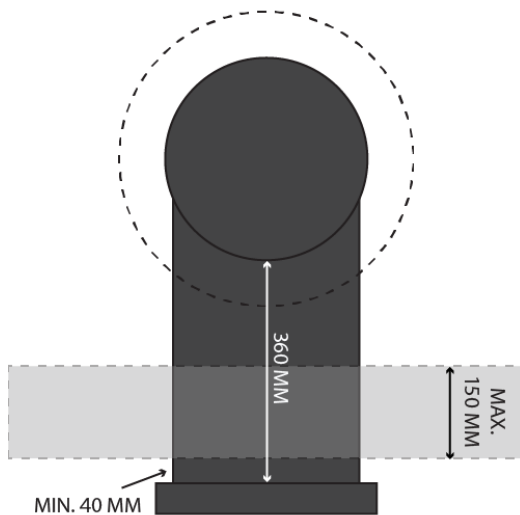

The thickness of the wall can be max. 150 mm. The front of the furnace has to be at least 40 mm away from the wall in order for the hatch to open up properly. The safety distance to a flammable wall surface needs to be **(A)** 300 mm in minimum from the lead-through in the wall **(C)**. If the stove is installed through a log wall a non-combustible heat shield must be used around the fireplace, as shown in the figure **(B)**. IKI-Kiuas also recommends the use of a spark damper in the front **(D)**.

3.5 Measurements and height for a 90-degree angled stove pipe

The height of the chimney connection pipe is measured from the floor level to the centre of the pipe. The outer diameter of the stove pipe is 115 mm.

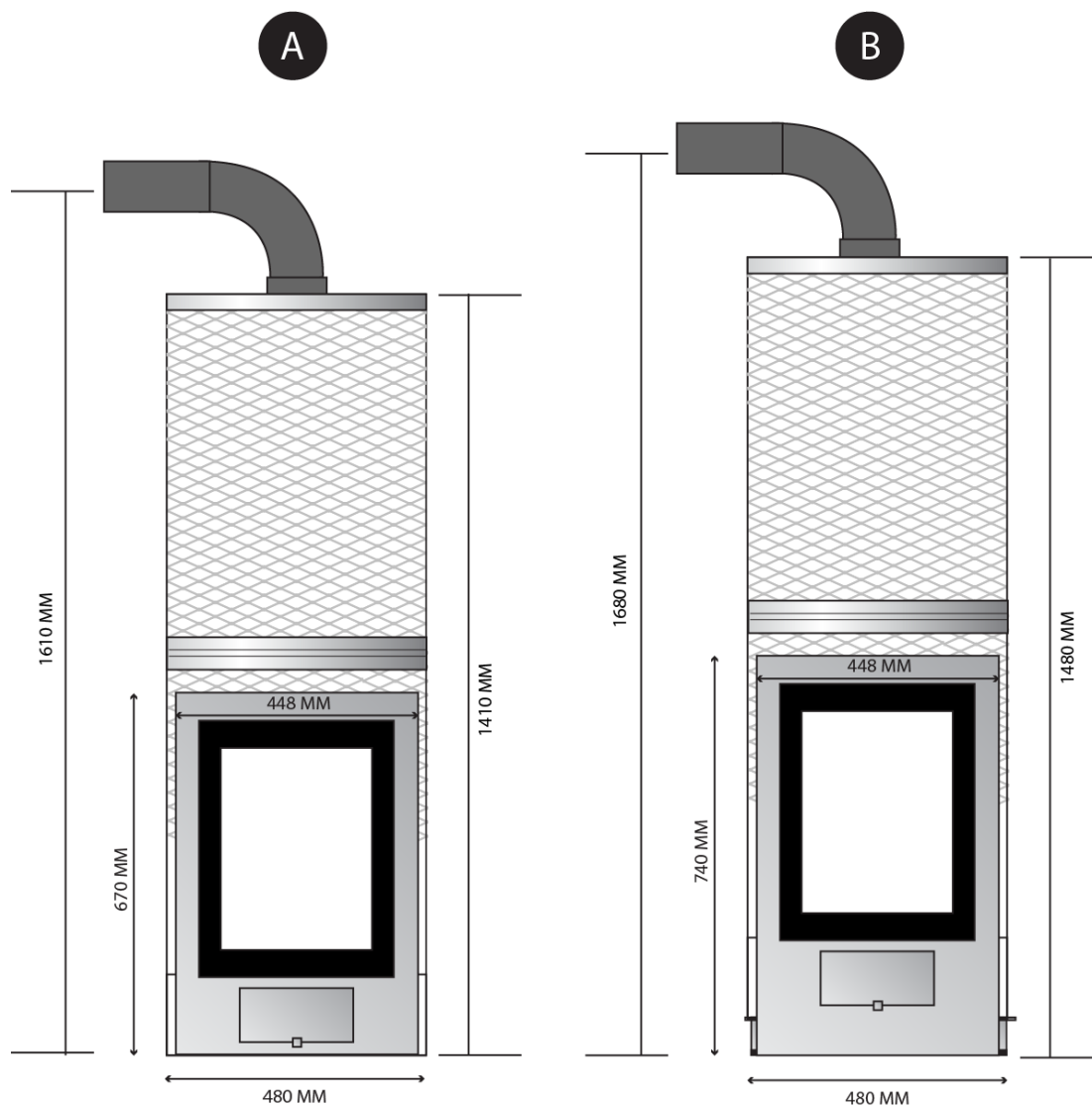

A: A stove without a stove baseplate. Wall protecting heat shield measures 670 mm x 448 mm.

B: A stove with an IKI stove baseplate. Wall protecting heat shield measures 740 mm x 448 mm.

The height of the stove base is **70 mm**.

Wall protecting heat shields are available in black and stainless steel. **NOTE! When ordering the heat shield, you need to know whether you intend to use a stove base as this determines the size of the shield.**

If the stove will be connected to the IKI T600 chimney, a 30 cm mesh adapter is included in the delivery. The diameter of the adapter is 250 mm.

4. VENTILATION AND COMPENSATION AIR

Careful planning of the sauna room's ventilation is necessary to ensure the stove gets enough air to burn cleanly and the bathers get fresh air for breathing. Good ventilation is also required to dry the sauna room properly after bathing.

The air that feeds the fire must be led in from outside the heating space (room), using a pipe equipped with a 50-100 mm grate and a disc valve. Fresh air should be directed towards the stove with, for example, a 100 mm pipe.

Inside the sauna the fresh air is led into the sauna through an air vent in the door or a gap underneath the door. Sufficient flow of fresh air to the washing /changing room must also be ensured. Air should be allowed to flow into the sauna quite freely during bathing and drying of the room. Make sure the air inlets do not get obstructed.

Exhaust air is led out of the sauna preferably through a hole equipped with a disc valve and an adjustable grid, placed between the lower and upper benches. The exhaust air should flow through a metal channel inside the wall and to exit just below the roof on the outer wall. The exhaust vent can also be in the ceiling or near the ceiling on the wall opposite the stove.

With machine assisted ventilation, the circulation of air and ventilation of the room is more efficient. The air flow principles and intake and exhaust vent locations remain the same.

The use of chimney fans is not recommended with wood-burning sauna stoves. The high temperatures of the combustion gases may break the ventilator. If there is more than one furnace in use, the combustion gases from each furnace must be directed to a separate exhaust vent. For example, using a cauldron and a stove requires a 2-passage chimney. The air inlets must be measured as per situation (two furnaces, adjustable vents, etc.).

5. INSTALLATION OF THE STOVE

5.1 Installation

Beware of the sharp edges on stainless steel the mesh frame. **Use a long-sleeved shirt and protective gloves during installation and laying of the stones.** All local fire safety regulations, including national and European standards, need to be adhered to. The stove is not suitable for use with a shared flue/chimney.

1. Make a hole in the wall for the furnace (**PIC 1**). The hole needs to be 345 mm in width and 630 mm in height. **NOTE!** If you are using an IKI stove base, the hole needs to be located 70 mm higher.
2. The stove should be located on concrete or stone floor surface, otherwise a protective shield needs to be placed underneath the stove, ideally a metal shield with an air gap (e.g., IKI stove base). The stove must not be installed on a floor that is water-proofed or has under floor heating, unless a protective shield or stove base is used. Also ensure the appropriate safety distances from page 8.
3. Remove protective plastics from the stove.
4. Install the heat shield around the hole in the sauna room wall (**PIC 2**). The shield can be affixed with heat resistant glue or screws.
5. Insert the front of the furnace through the wall (**PIC 3**).
6. The front of the furnace should come at least 4 cm away from the wall, in order for the hatch to have adequate space to open (**PIC 4**).
7. Place the stove pipe on top of the stove, check that chimney connection pipe is in place and make sure the stove is horizontally level (**PIC 5**).
8. Install the heat shield around the hole on the other side of the wall (**PIC 6**). The shield can be affixed with heat resistant glue or screws.
9. Insert the ash pan in place and affix the hatch making sure that the hatch has room to open (**PIC 7**). Reposition the stove, as needed. See separated instructions for affixing the hatch, on page 13.
10. Fill the lower part of the mesh frame with stones, one at a time, placing them all the way around the furnace (**PIC 8**). We recommend stones the size of 10 cm in diameter, e.g., rough cut olivine or olivine diabase stones. The stones should cover all metal parts as well as go underneath the furnace.
11. Place the upper mesh frame so that the rim fits on the outside of the lower frame and the logo is on the opposite side from the wall lead-through (**PIC 9**).
12. Lay stones on the upper part of the frame (**PIC 10**).
13. Insert the grate to the bottom of the furnace.

DURING USE, PLEASE NOTE: The surface of the stones will descend with time, when the stove has been in regular use. The frequency with which the stones need to be changed depends on the quality of the stones and the stove's use rate. In standard use, check the condition of the stones each year, remove broken stones and replace them with new ones. Make sure that the furnace does not get exposed as the stones shift; if necessary, add or reposition stones to keep the furnace fully covered. The exposed furnace might cause a risk of fire.

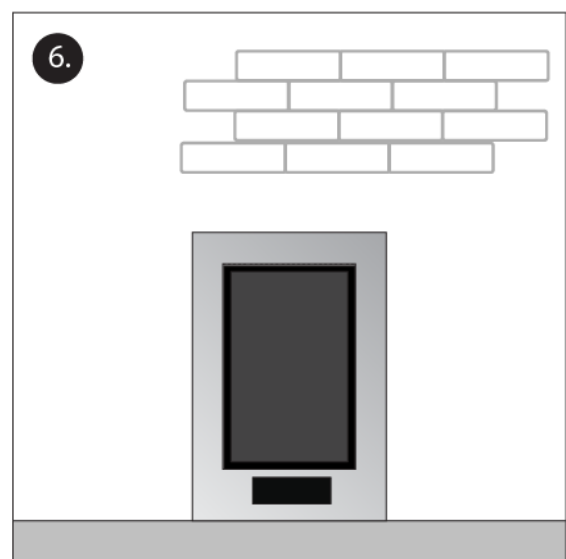
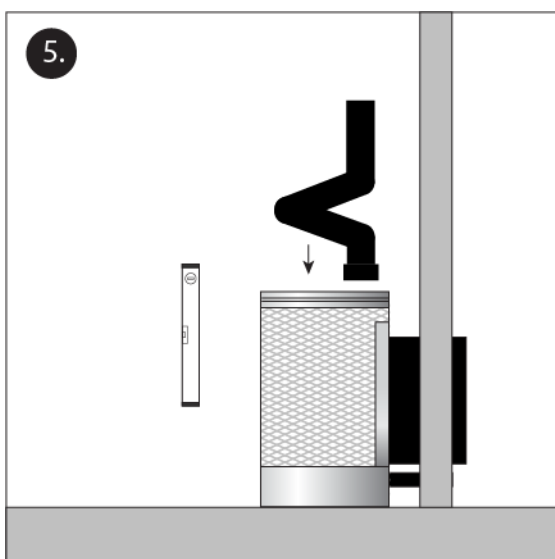
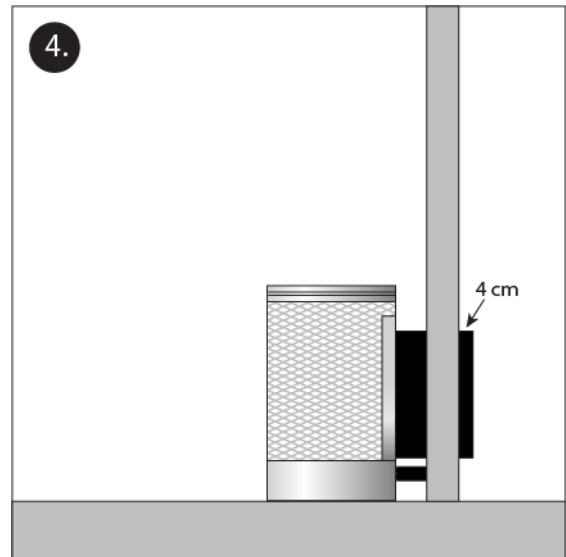
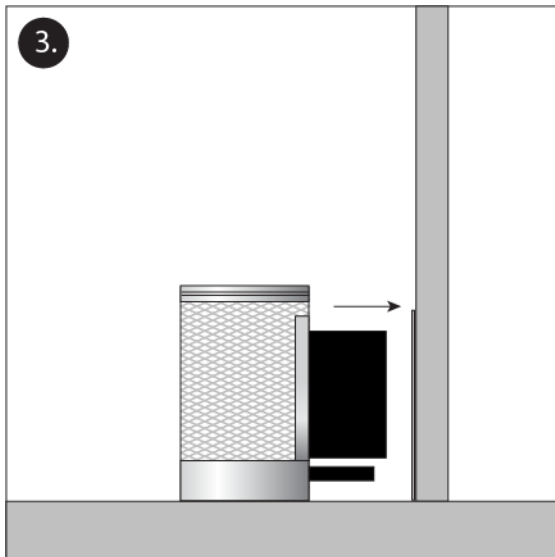
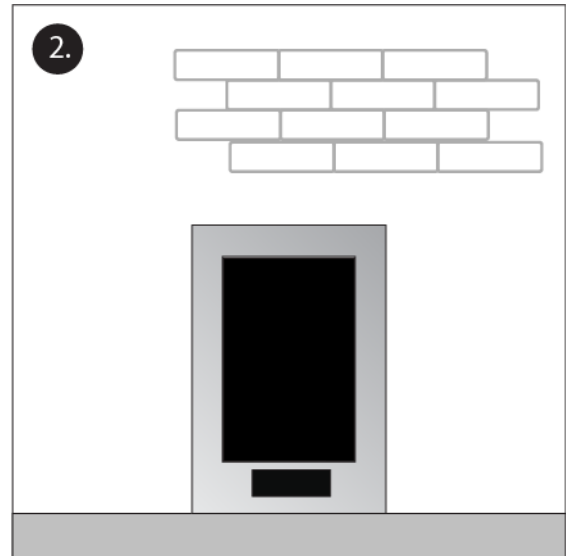
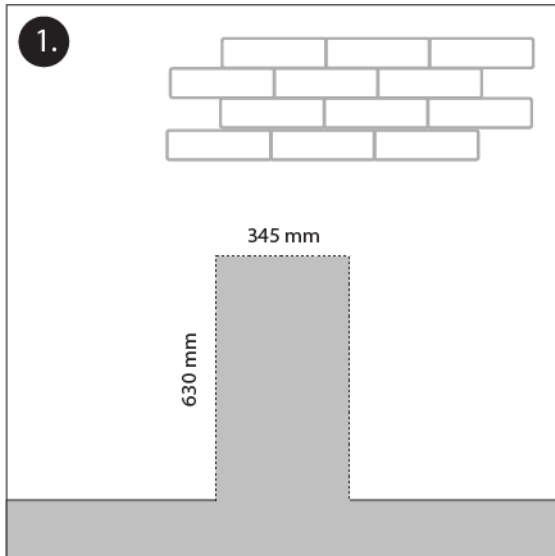

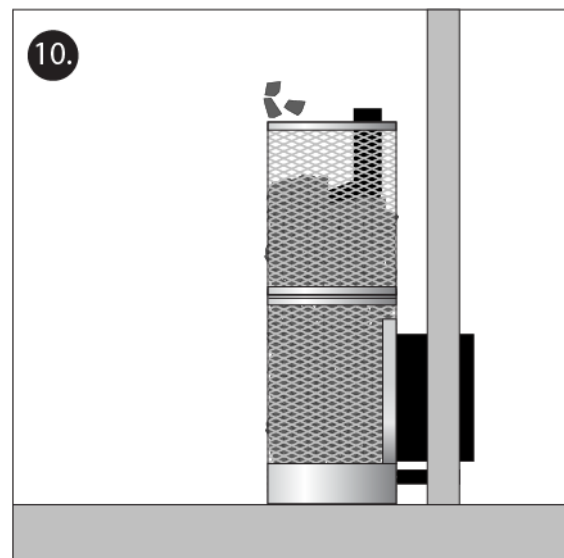
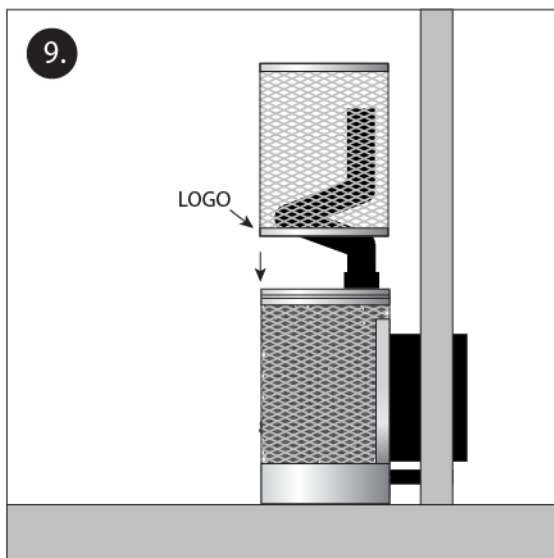
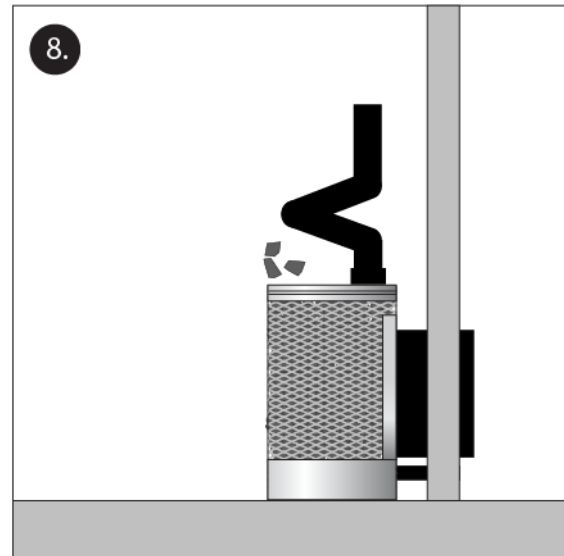
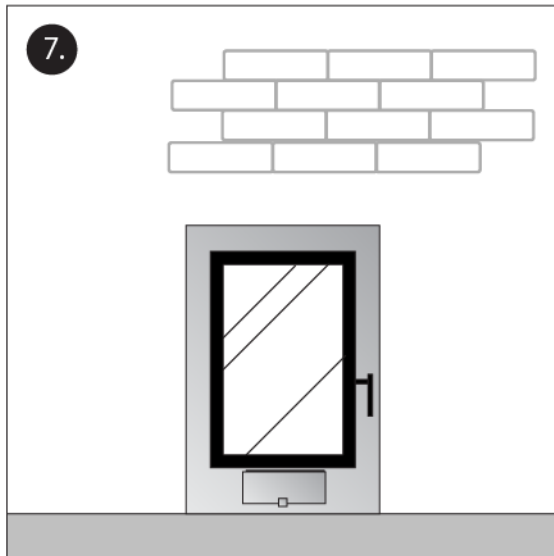

5.2 Affixing the glass hatch



PIC 1

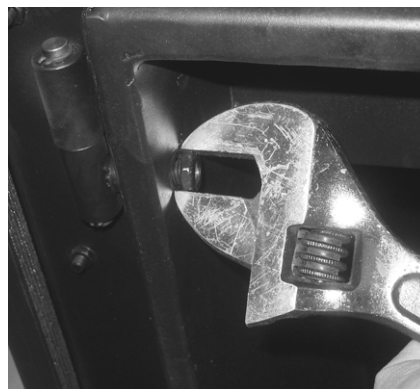

PIC 2

PIC 1: Affix the hatch to the front of the furnace. There are appropriate holes in place for the hinge bolts.

PIC 2: Screw in the bolt nuts and tighten them from the inner side of the hatch.

Note! The bushings should be installed between the neck and the hinge outer side of the neck.

6. INSTRUCTIONS FOR USE

The heating time of the saunastones is about 60-90mins, depending on the size of the sauna room , ventilation and the size of the stove. The correct bathing temperature for IKI stoves is approximately 55-70 degrees.

6.1 Lighting the fire

- Clean the ashes and remnants of previous use from the furnace.
- Open the damper on the chimney and ensure good flow of air.
- The maximum amount of firewood is 2/3 of the furnace's total volume, approximately 3 or 4 logs at a time.
- Place the logs sparsely in an upright position on top of the grate in the back of the furnace. **Do not place logs on the front of the furnace (see image on the right).**
- Set light to the kindling and close the hatch. You can adjust draft by pulling the ash pan slightly out. The stove is not intended to be used with the hatch open.
- When the fire starts to die down, add more logs if bathing continues. Use the ash spatula included in the package to move the embers around.
- Recommended size for the logs is 12-15 cm in diameter. Once the sauna room has reached bathing temperature, add every now and then few logs is sufficient to keep the heat at the steady level.

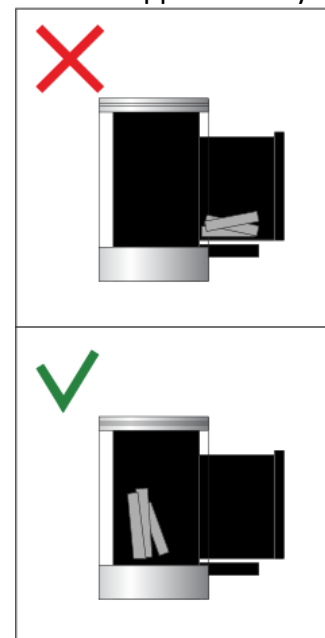

Note! The handle on the hatch might get hot as the stove heats up. Use the protective gloves included in the delivery to open the hatch as needed. In the beginning, as you build the fire, the ash pan can be slightly ajar to provide a draft for the fire. During bathing and when the sauna room has warmed up, the ash pan can be closed, or the gap narrowed down, in order to control the fire and expenditure of wood. Ensure there is adequate air for the fire to burn and for ventilation. Make sure the air inlets do not get obstructed. The stove's grate is a part that may wear down and needs to be replaced if it breaks.

Adding fuel to the fire:

Initial charge is 3,5 kg, additional charges 4 pcs, added quantity 3,5 kg. The stove's hatch must be kept closed to prevent smoke leaks, except for the duration of the ignition, refueling and removal of residue. Dry wood is the best fuel. The moisture content of the wood has a significant effect on both the purity of the combustion and the efficiency of the stove. Birchbark, lighter cubes and newspaper work well as tinder.

Do not burn the following things in the stove:

- Fuel that burns with a high temperature (e.g., particle board, plastics, coal, briquettes or pellets).
- Painted or treated wood.
- Trash (e.g., PVC, textiles, leather, rubber or disposable diapers)
- Garden compost (e.g., grass cuttings or leaves)
- Liquid fuels

6.2 Care and upkeep

NOTE! It is possible for the fireplace hatch to change colour in time, or for the paint to wear off. You can repaint the hatch using paint that is heat-resistant up to 600 degrees. Before painting, the metal parts of the hatch should be sanded and degreased. The glass and the inner surfaces of the hatch should be cleaned at least once a year, as ash accumulates in the joints. The condensed ash and the resulting pressure can, at worst, crack the glass.

6.3 Trouble shooting

Get in touch with our customer support in all and any problems relating to the use of the stove. The contact information is written on page 2.

Some of the most common issues and appropriate solutions are listed below:

1. Check the purchase receipt to see if the warranty applies (see more on page 5).
2. Read through the common problems listed below and attempt to solve them.

THE PROBLEM	HOW TO SOLVE IT
No draft in the stove	<ol style="list-style-type: none"> 1. Check the chimney for blockages (e.g., bird's nest), and make sure the damper is open. 2. Has the chimney been swept accordingly? 3. Is there a low-pressure air front? Burn some paper in the furnace first, keeping the hatch open. 4. Check firewood is dry.
The draft is too strong	<ol style="list-style-type: none"> 1. Adjust the draft. 2. If the chimney pipe is high, use the damper to minimise air flow.
Sauna does not get warm	<ol style="list-style-type: none"> 1. Is the stove big enough for the size of the sauna room? (space, insulation, log walls vs stone surfaces) 2. Is the ventilation designed correctly? 3. Are there enough stones in the stove and have they been piled correctly? 4. Check the condition and quality of the stones (use olivine-diabase stones, smaller than 10 cm in diameter)
The stones do not heat up properly	<ol style="list-style-type: none"> 1. Are there enough stones, have they been laid correctly? 2. Check the condition and quality of the stones (use olivine diabase stones, smaller than 10 cm in diameter) 3. Is the firewood dry and has it been loaded according to the instructions?

Features of the water	Effect	Recommendation
Humus content	Colour, taste, precipitation	< 12 mg / l
Iron in the water	Colour, smell, taste, precipitation	< 0,2 mg / l
Hardness: The main ingredients manganese (Mn) and calcium (Ca)	precipitation	Mn < 0,05 mg / l Ca < 100 mg / l
Chlorinated water	Health hazard	PROHIBITED!
Sea water/ salt water	Fast corrosion	PROHIBITED!

6.4 Instruction for sweeping

1. Start by removing the stones from the stove until you reach the coiled pipe.
2. Open the sweeping hatch in the pipe (as seen in picture below). This does not require any tools.
3. Sweep the pipe using, for example a pliable nylon brush. DO NOT USE a metal brush! It might damage the inner surface of the pipe and cause early corrosion.
4. The pipe can alternatively be cleaned using an industrial vacuum cleaner.
5. Finally spray or pour some water and/or use the brush to clean up the detachable smoke pipe.

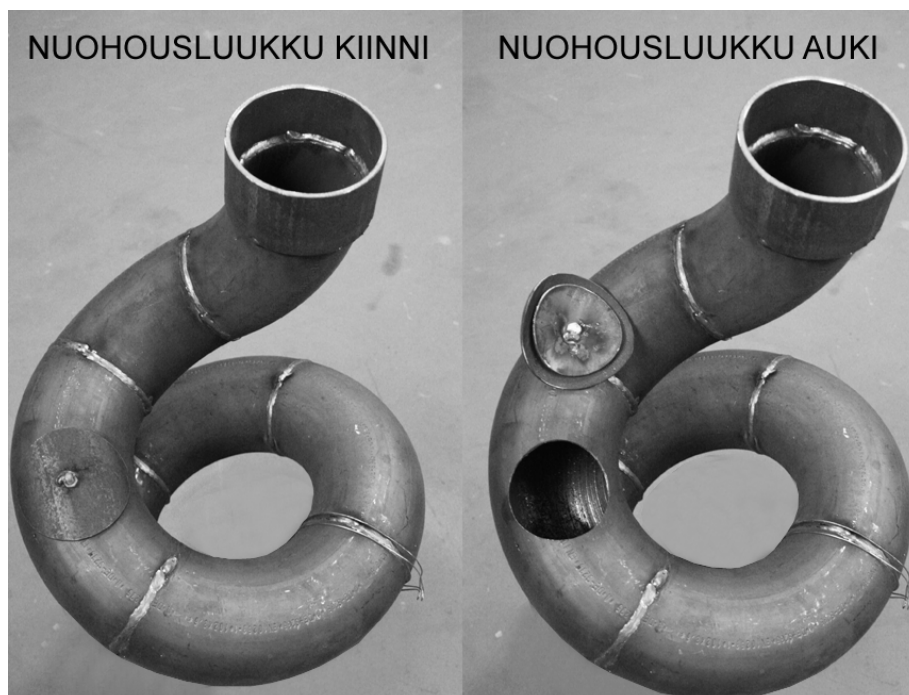

6.5 Protective base for the stove

If you intend to install the stove on a flammable floor surface (e.g., wood), a plate of non-combustible material must be placed underneath as a protective base. The size and shape of the board must be calculated based on the safety distance requirements. The floor at the front of the fireplace should also be protected with, for example, a spark damper. IKI-Kiuas product range includes a 50 cm diameter stove base. The base has adjustable legs. The protective base is also suitable for use with a tiled and waterproofed floor, reducing the heat radiation to the floor.

7. WARNINGS

- Use protective gloves and a long-sleeved shirt when handling the stove's mesh frame and when placing the stones into the stove as there may be rough edges in the frame.
- Prolonged stay in a hot sauna raises the body temperature, which can be dangerous.
- Be careful with the hot stove. The stones and metal parts heat up to burning hot.
- Do not throw water on to the stove if anyone is close to the stove. The hot steam can cause severe burns.
- Prevent children from going near the stove.
- Do not leave children, disabled, ill or poorly people to bathe without supervision.
- Check with your doctor about any health restrictions associated with sauna bathing.
- Consult the child welfare clinic about taking babies to the sauna.
- Always move carefully in the sauna, as the benches and floors may be slippery.
- Never go to a hot sauna under the influence of alcohol, medication or narcotics.
- Never sleep in a hot sauna.
- Sea-air and a humid climate may corrode the metal surfaces.
- Do not hang clothes to dry in the sauna, as this may cause a risk of fire.
-

NOTES:



IKI

KIUKAISTA KIUKAIN

Copyright IKI Kiuas Plc – We reserve the right to make changes.

